

3-Channel Professional Colour NAVTEX

Sirius-3 is a 3-channel NAVTEX receiver for SOLAS vessels which comply with the new NAVTEX performance standard. The **Sirius-3** can simultaneously receive three channels.

Features:

- Large colour touchscreen 6.2" with daylight and night mode
- 3 parallel operating receivers for all IMO Navtex frequencies
- 1,000 messages memory with quick select
- 12/24V DC supply
- Low power consumption
- NMEA interface
- Compatible with Thrane Link
- Printer interface
- Wheel marked
- Waterproof from front
- Interface for central muting of alarms
- USB Interface
- Green Passport

Options:

- Active 3 frequency antenna NA-3
- Flush Mounting Kit
- Tabletop or bulkhead mounting bracket
- USB Printer

Approvals:

- Wheel Mark, FCC (US) and IC (Canada)

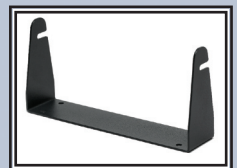
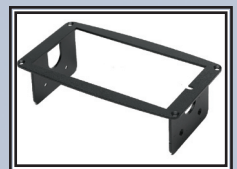

Polaris Electronics A/S

Kærholt 1 • P.O. Box 7957 • DK-9210 Aalborg SØ

Tel.: +45 9631 7900 • Fax: +45 9631 7901

E-mail: info@polaris-as.dk • Web: www.polaris-as.dk

ISO 9001
BUREAU VERITAS
Certification



DIMENSIONS

202 mm



Built-in dimension: 100 x 200 mm

68 mm

102 mm

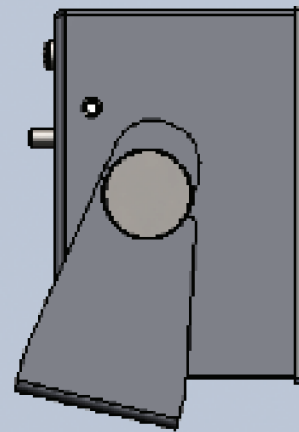

SPECIFICATIONS

Receiving mode	F1B NAVTEX Broadcast
Receiving frequencies	490, 518 & 4209.5 kHz
Display	6.2" Colour Touchscreen
Menu languages support	English
Received messages	Each Channels: 1,000 Messages
Data Backup	72 Hours
Rear Connections	Antenna PL259 (12V DC to Active Antenna) Power, Alarm, Mute RS422 NMEA 0183 Input- /Output USB: Printer, Software Update Earth Connection
Power supply	12/24V DC Nominal (10 to 29V DC)
Operating Temperature Range	-15 C to +55 C
Storage Temperature Range	-20 C to +55 C
Humidity	0 to 95%, non-condensing

CONFIGURATIONS

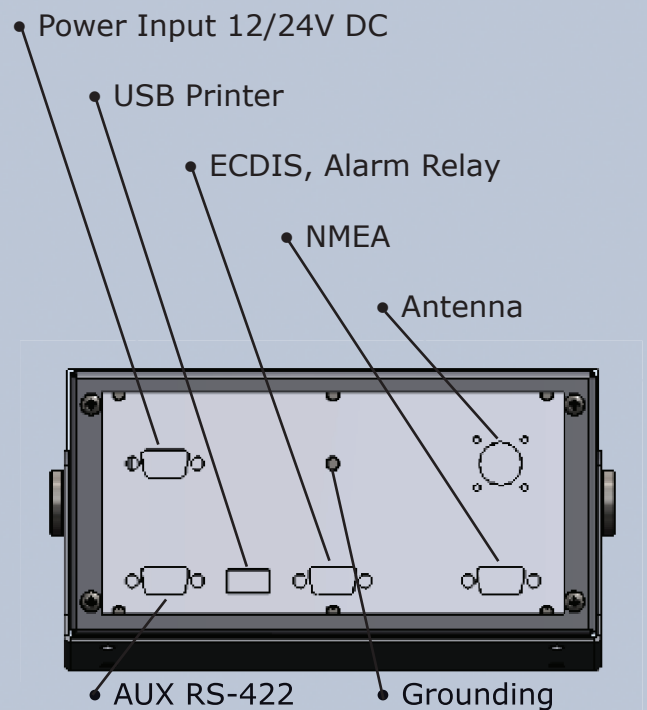

For further information, contact: